

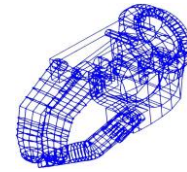

International Society for Prosthetics and Orthotics
United Kingdom National Member Society

**Trent
International
Prosthetic
Symposium**

2012



*... the premier event dedicated to the management of upper extremity
amputees and limb deficient children*



**Burleigh Court
Conference Centre
Loughborough, UK**

21st to 23rd May 2012

**PRELIMINARY PROGRAMME
AND
CALL FOR PAPERS**



Your invitation to participate at TIPS 2012

The Organising Committee, in conjunction with ISPO UK NMS, cordially invites you to participate at TIPS 2012 – *the premier international event* dedicated to the management of upper extremity amputees and limb deficient children.

Building on the success of TIPS 2009, but remaining true to its original ethos, the meeting will return to the highly acclaimed **Burleigh Court Conference Centre** located in the heart of the Trent area, in the grounds of Loughborough University, only 8 miles from East Midlands Airport. Rail links, with regular train services, lead to other major UK airports including Birmingham, Heathrow and Gatwick. For travellers by car, this first class conference centre is situated just one mile from Junction 23 of the M1 and provides on-site secure car parking for all delegates.

The venue boasts high specification meeting rooms, versatile exhibition space, luxury en-suite bedrooms, therapy, spa and leisure complex and award-winning cuisine, all of which undoubtedly complement the quality conference and exhibition for which the **Trent International Prosthetic Symposium** is renowned. Full details, including a virtual tour of this unique residential conference centre, can be found at

<http://www.welcometomago.com/conference-venues/burleigh-court/>

The symposium will follow the successful format of previous years – a mix of guest lectures, invited speakers, free papers, short clinical papers, instructional workshops, exhibition and manufacturers' workshops. Together with a lively evening social programme, TIPS 2012 will once again provide a multi-disciplinary forum with a wide range of opportunities for delegates to engage with rehabilitation professionals from across the world.

You are encouraged to submit abstracts for free paper presentations as well as short clinical papers. Please feel free to e-mail our secretariat office (info@ispo.org.uk) giving advance notice of your intention to submit a paper – this will assist in ensuring that adequate time is allocated to this very important aspect of the conference programme.

We look forward to welcoming new and past delegates to TIPS 2012. See you in Loughborough!

PROVISIONAL CONFERENCE PROGRAMME

Monday 21st May

0830 hrs Registration
1000 hrs Welcome
1015 hrs Guest Speaker
1100 hrs Free Papers & Short Clinical Papers
1200 hrs Lunch
1200 hrs Exhibition Opens
1345 hrs Free Papers & Short Clinical Papers
1530 hrs Exhibition & Refreshments
1615 hrs Guest Speaker
1700 hrs Free Papers & Short Clinical Papers
1800 hrs Exhibition Closes
1930 hrs Informal Social Evening

Tuesday 22nd May

0830 hrs Registration
0900 hrs Guest Speaker
0945 hrs Free Papers & Short Clinical Papers
1100 hrs Exhibition & Refreshments
1130 hrs Free Papers & Short Clinical Papers
1215 hrs Exhibition & Lunch
1400 hrs Exhibition Closes
1400 hrs Guest Speaker
1445 hrs Manufacturers' Workshops
1545 hrs Refreshments
1600 hrs Manufacturers' Workshops
2000 hrs Symposium Dinner

Wednesday 23rd May

0830 hrs Registration
0900 hrs Guest Speaker
0945 hrs Free Papers & Short Clinical Papers
1030 hrs Refreshments
1100 hrs Free Papers & Short Clinical Papers
1200 hrs Lunch
1300 hrs Instructional Workshops
1400 hrs Refreshments
1415 hrs Instructional Workshops
1515 hrs Prizegiving
1530 hrs Symposium closes



GUEST SPEAKERS

Confirmed guest speakers for TIPS 2012 include:-

Randall Alley – CEO and Chief Prosthetist for **biodesigns** – a technology-driven high performance prosthetic facility specialising in advanced upper and lower limb patient care and product development. With nearly 20 years experience in upper limb prosthetics, Randall has travelled the US and abroad working on complex upper limb cases and has trained hundreds of practitioners in upper limb prosthetic care, clinical techniques and innovative interface designs. He also works with DEKA Research as their chief prosthetic interface design consultant for the DARPA 'Revolutionizing Prosthetics Project'. An international lecturer and clinical columnist, Randall has contributed to five upper limb textbooks and is a recent recipient of the Clinical Creativity Award from the American Academy of Orthotists & Prosthetists (AAOP).

Dr Oskar Aszmann – Professor of Plastic and Reconstructive Surgery at the Medical University of Vienna, Oskar Aszmann received part of his training at the John Hopkins Hospital in Baltimore, MD and joined the Division of Plastic Surgery in Vienna, Austria in 1998. Both his research and clinical focus have always been peripheral nerve reconstruction and extremity/hand rehabilitation. Since 2006 he has been collaborating closely with Otto Bock to explore the possibilities and limits of bionic reconstruction which has now led to the establishment of a Center for Extremity Reconstruction and Rehabilitation.

Diane Atkins, OTR, FISPO – An internationally recognised Occupational Therapist specialising in upper limb amputee rehabilitation for the past thirty five years, Diane Atkins is Clinical Assistant Professor in the Department of Physical Medicine and Rehabilitation at Baylor College of Medicine in Houston, Texas. She has taught on several occasions to the clinical rehabilitation teams at Walter Reed and Brooke Army Medical Centres on the management and care of soldiers who have sustained upper limb loss. Diane is the co-editor and author of two text books relating to the comprehensive management of children and adults with upper extremity amputation, as well as several journal articles. She is a Fellow in the International Society of Prosthetics and Orthotics and Honorary Member of the American Academy of Orthotics and Prosthetics.

Danny Crates – One of the world's most inspiring athletes of the modern era, Danny Crates faced a promising rugby career, playing at both regional and county level until in 1994 whilst travelling and working in Australia he suffered a horrific accident losing his right arm. Not to be deterred, Danny resumed his rugby activities, becoming the only known arm amputee playing club rugby in the country, receiving worldwide media attention. He turned his attention to athletics and, as a natural speedster soon found that he was competing with the best in the world in his event – the T46 400m arm amputee class. Recently retired from international competition, the 2004 Paralympic Champion, European Champion, Paralympic World Cup winner and world record holder has some amazing achievements and an amazing story to share.

Professor Simon Kay, FRCS, FRCS (Plas), FRCS Ed (Hon) – Consultant in Plastic and Reconstructive Surgery & Surgery of the Hand, St James University Hospital, Leeds. A pioneer of microsurgery in reconstruction of congenital defects of children's hands, Professor Kay specialises in research in the fields of children's hand reconstruction, brachial plexus surgery and nerve repair. He has published extensively and is co-editor of the world's major textbook in children's hand surgery. A Professor of Hand Surgery at the University of Leeds, Mr Kay is also an Honorary Visiting Professor at Umea University in Sweden where he has developed joint study higher degrees for postgraduate students.

CALL FOR ABSTRACTS & SHORT CLINICAL PAPERS

You are invited to submit **free paper abstracts**. All abstracts will be reviewed and authors of accepted papers will be invited to give a 12-minute presentation at TIPS 2012. Guidelines for the preparation of abstracts are available on the Symposium website at http://www.ispo.org.uk/events_meetings-V.html.

Sharing practical experience and knowledge is invaluable and the organisers encourage the submission of **short clinical papers** by clinicians who have developed solutions to problems encountered in everyday practice but which may not provide sufficient content for a full free paper presentation. Authors of accepted clinical papers will be invited to give 5-minute presentations at the Symposium. Full abstracts are not required – for guidelines see the website at:- http://www.ispo.org.uk/events_meetings-V.html

MANUFACTURERS' WORKSHOPS

A regular and popular highlight of the Trent Symposium are the Manufacturers' Workshop Sessions where international companies offer delegates the opportunity to attend small group sessions focussing on areas of specific interest to upper-extremity prosthetic professionals.

INSTRUCTIONAL WORKSHOPS

Instructional workshops covering **paediatrics, prosthetic socket design, residual limb conditioning & exercise tolerance, graded motor imagery and driving with limb loss** will provide delegates with an opportunity to gain practical instruction from some of the world's leading upper limb professionals.



EXHIBITION

The commercial exhibition will run from 12 noon on Monday through to 2.00 pm on Tuesday providing delegates with the opportunity to see first-hand the latest innovations in prosthetic design and manufacture. Delegates are strongly encouraged to visit the exhibition stands and discuss areas of interest with representatives from many of the major national and international companies specialising in upper-extremity prosthetics and rehabilitation.

SOCIAL PROGRAMME

Delegates are encouraged to participate in the conference social programme, including an informal meal and social event on the Monday and more formal Symposium dinner on Tuesday evening. Details of how to book tickets for each event are available on the enclosed registration form.

REGISTRATION

Delegates wishing to register for TIPS 2012 should complete the enclosed registration form and return it to the TIPS 2012 Organising Committee at ISPO UK NMS Secretariat, PO Box 2781, Glasgow, G61 3YL. Registration forms can also be downloaded from the Symposium website at http://www.ispo.org.uk/events_meetings-V.html

ACCOMMODATION

Burleigh Court offers a range of quality en-suite bedrooms at specially negotiated rates for conference delegates. To book accommodation, please telephone Burleigh Court Accommodation Reservations at + 44 (0) 1509 228140 (e-mail: beds@welcometomago.com) and quote reference **98956**. All residents have full access to the restaurant, bar and lounge facilities as well as use of the Leisure Club and Spa Complex comprising a 15m swimming pool, sauna, whirlpool spa, steam room and fully equipped gymnasium. Secure on-site car parking is available to all delegates.

Lodge Room (Room Only) £59.00 (sole occupancy)
Lodge Room (Bed & Breakfast) – £69.50 (sole occupancy)
Executive Room (Bed & Breakfast) £102.00 (sole occupancy)
Executive Room (Bed & Breakfast) - £123.00 (double occupancy)

TRAVEL

By Road

Leave junction 23 of the M1, taking the A512 Ashby Road to Loughborough. At the first roundabout, turn right into Holywell Way (signposted for Burleigh Court and Holywell Park). Turn left at the next roundabout and enter Loughborough University Campus using the West Entrance. Take the first right after the gatehouse into Burleigh Court Car Park. **Satellite Navigation** - Please use the postcode **LE11 3GR** or type '**Holywell Way, Loughborough**' into your satellite navigation system. (NB: Postcodes for imago and Loughborough University, will not take you to your required destination)

By Train

Loughborough mainline station is located only 3 miles away. Regular intercity services operate from London St Pancras direct to Loughborough. This service is a 90 minute journey. Burleigh Court is located at Loughborough University and is only a ten minute taxi ride from the station, or 30 minutes using the University Shuttle bus service. For train times please visit: www.midlandmainline.com

By Bus

The popular University Shuttle bus operated by Kinchbus, travels between the University and Loughborough's train station, with the service running every 10 minutes during term time and 20 minutes out of term time. Kinchbus also operate an evening service from the University to Loughborough town centre and back from 6pm until 9pm each Monday to Friday evening during term time. The bus route timetable can be found at www.kinchbus.co.uk

By Air

Burleigh Court, located at Loughborough University, is just 8 miles from East Midlands Airport and convenient for Birmingham International Airport via the M42. www.eastmidlandsairport.com www.bhx.co.uk

IMPORTANT DATES

Tuesday 31st January 2012
Friday 20th April 2012

Closing date for receipt of free paper abstracts & short clinical papers
Last day for early bird registration

FURTHER INFORMATION

Full details of the conference, together with regular updates, are available on the Symposium website at http://www.ispo.org.uk/events_meetings-V.html or by contacting Irene Cameron at ISPO UK NMS Secretariat, PO Box 2781, Glasgow, G61 3YL, T/F: + 44 (0)141 560 4092 E: info@ispo.org.uk W: www.ispo.org.uk

